

# manything...

## Installation Guide

IP cameras recording directly to cloud (no local DVR/NVR)



**m...**

V1 - Dec 2019

## 1. How it works

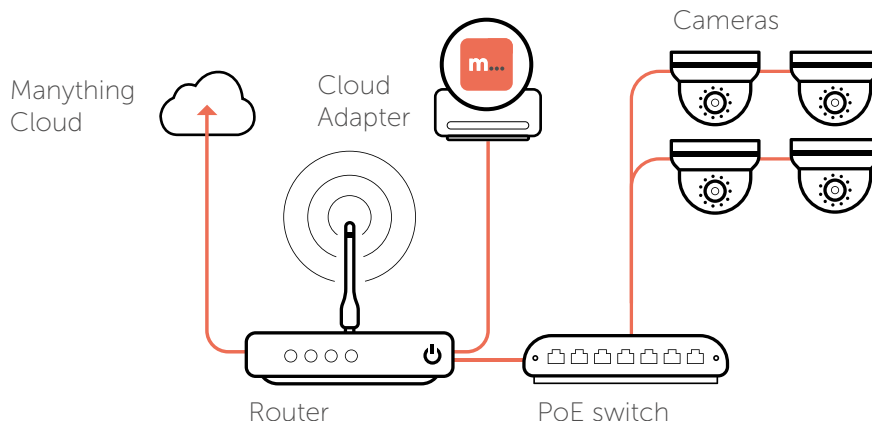

## 2. Pre-installation

### 2.1 What you'll need

- Manything Cloud Adapter
- Smartphone or tablet with the latest Manything app (iOS 10 or above, Android 4.2 or above)

### 2.2 Compatible IPc cameras

- All Hikvision IP cameras, including Hikvision OEM. Please contact us if:
  - The cameras have very old firmware, it might need to be updated for our software to work
  - You want to use specific Hikvision OEM brands, we haven't tested them all but will be able to advise further if you tell us the model numbers

### 2.3 Your account

- Download the Manything app and login with your username and password

## 3. Installation

### 3.1 Network

- Make sure that the smartphone or tablet you are using for the installation is on the same network as the cameras and Cloud Adapter. Check that you have the latest version of the Manything app and log in with your account credentials.

## 3.2 Finding your phone's IP address

- Head to Settings > Wi-Fi. If you're not already connected to the network, tap it and connect now.
- Tap the network's name to open its options; if you're using Android, you will need to expand the Advanced section.

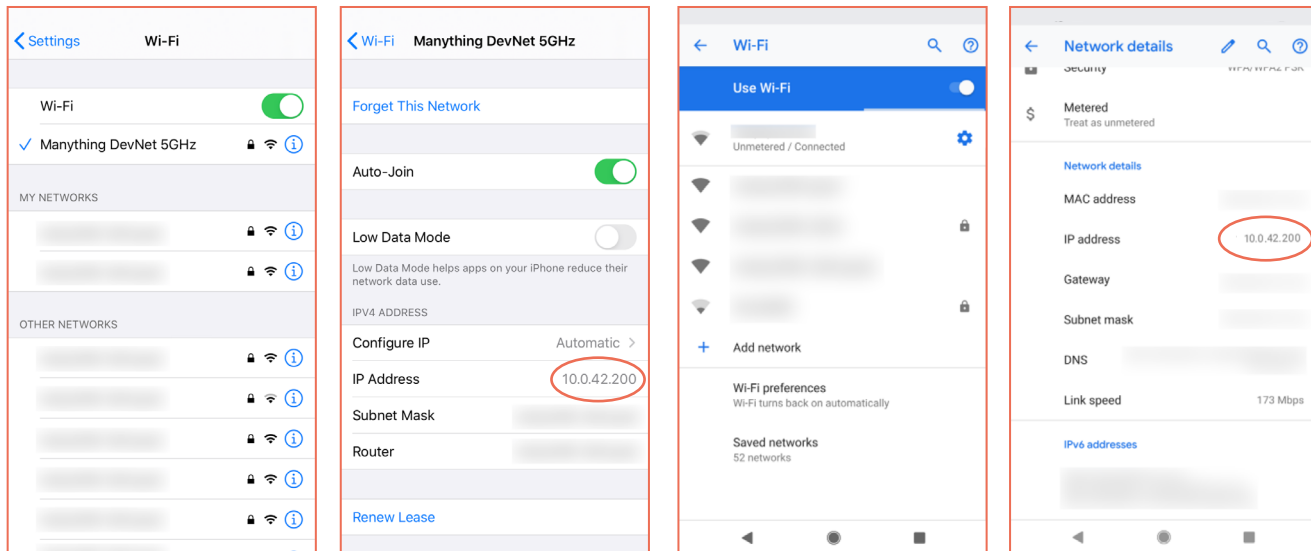

## 3.3 Setting up Cloud Adapter

- Ensure that cameras are connected to power and network
- Connect the Cloud Adapter to the same network **and then** power
- Tap 'Install Cloud Adapter' on the main menu to begin the installation process, enter the Cloud ID when prompted. This can be found on a sticker on the side of the Cloud Adapter'. Note that the Cloud ID is case sensitive.

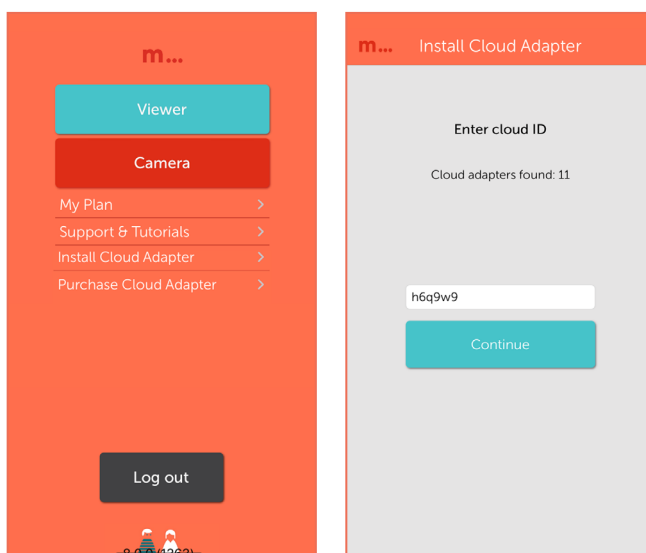

## 3.4 Discovering and selecting cameras

- Once you have entered the Cloud ID, you will be asked if your system has a recorder, tap 'No'. The Manything app will then discover all cameras connected to the same network as your phone and the Cloud Adapter. If you are connecting more than 8 cameras to the cloud, see Appendix 1.
- Select the required cameras. You'll be prompted for the camera admin passwords (or asked to set new ones if the cameras are brand new)
- Once all cameras are authenticated they will show as 'Ready to install'
- Tap 'Next' to continue

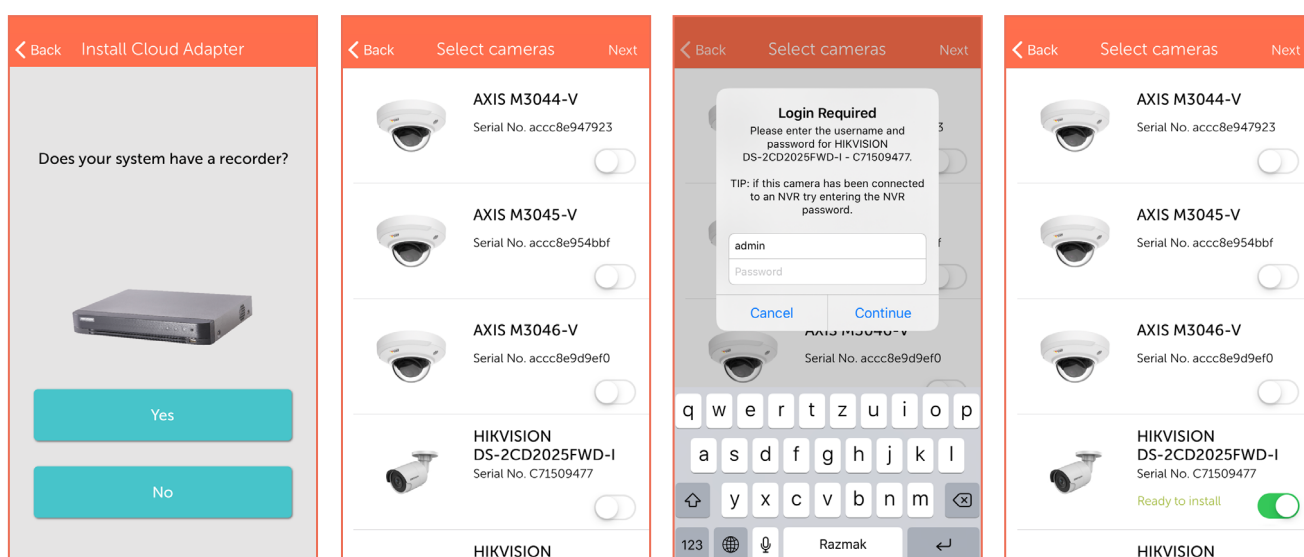

## 3.5 Completing installation

- When prompted, disconnect Cloud Adapter temporarily from power and then reconnect. Stay on app screen for approx 1 min while the Cloud Adapter reboots.
- Once installation complete, tap 'View cameras'

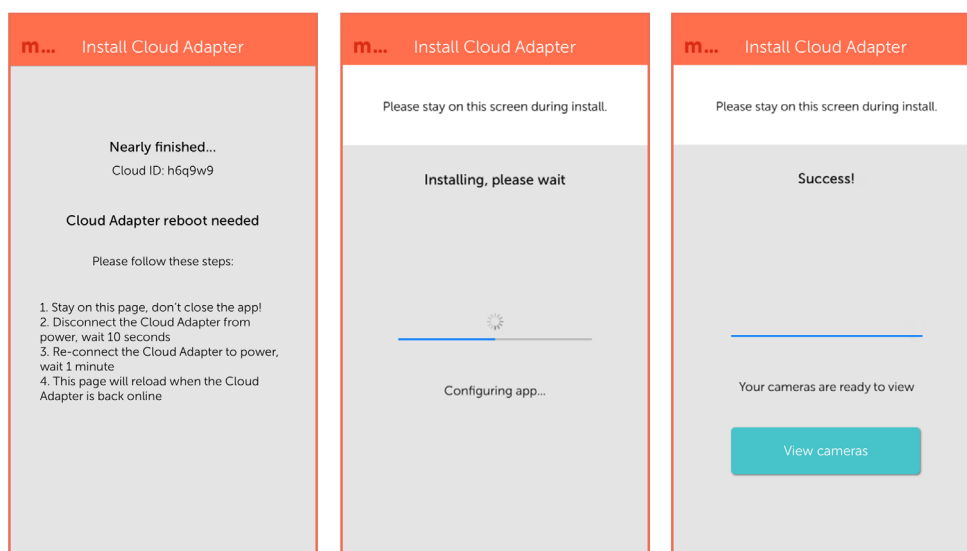

## 4. Post-installation

- Once the installation is complete, tap 'View cameras'. For each camera:
  - Check that the live feed is working (allow time for it to connect)
  - Check that motion activated events are being recorded
  - Tap the settings cog and amend any settings as required

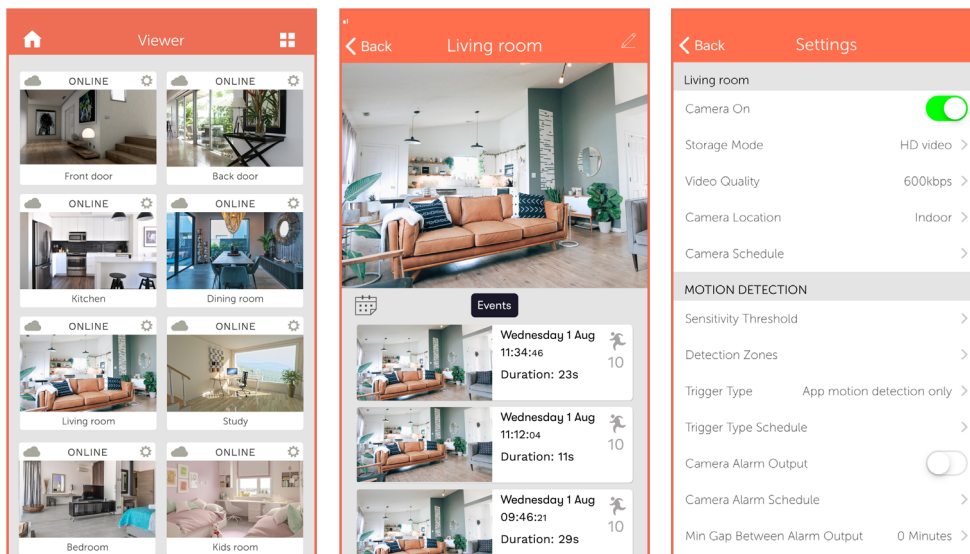

Please note: If the cameras were brand new you'll need to ensure every camera has a valid, routable IPv4 address. You can do this by enabling DHCP or assigning static IP addresses.

## Appendix 1

- If you are connecting more than 8 channels to the cloud you'll need to set up multiple Cloud Adapters on your account. We recommend doing them one at a time, following the steps in this guide. Once you have installed the 1st Cloud Adapter, the app will show you which channels are already connected to the cloud to help you choose which ones to select during the installation of the 2nd Cloud Adapter.